

**SPECIFICATIONS**

ELECTRICAL RATING: 0.5A 24VDC; 0.2A 48VDC  
 CONTACT RESISTANCE: 100 mΩ MAX.  
 INSULATION RESISTANCE: 100 MΩ MIN. 500VDC  
 DIELECTRIC STRENGTH: 500VAC for 1 minute  
 OPERATING FORCE: 350±150g (D)  
 OPERATING LIFE: 2,000 cycles  
 PERATING TEMPERATURE RANGE : -20°C ~ 70°C

MATERIAL  
 HOUSING: NYLON 6/6  
 BASE: LCP  
 ACTUATOR: NYLON 6/6  
 TERMINAL: Brass gold plating.  
 RoHS: 2002/95/EC

P.C.B. LAYOUT

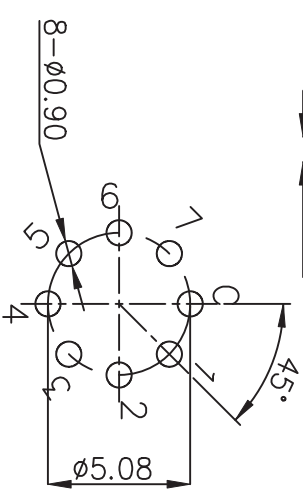

TRAVEL	SWITCH POSITION
0°	C-C(OFF)
45°	C-1
90°	C-2
135°	C-3
180°	C-4
225°	C-5
270°	C-6
315°	C-7

符號	原尺寸	修改後尺寸	變更日期	SCALE (比例) : 4 : 1	TITLE	SIZE
1	(A)	圖面重新整理	OCT-19-2010	TOLERANCE (公差) : 0.00 mm ± 0.25mm 0.0 mm ± 0.40mm ANGULAR : ± 5° FILE NAME : RT0001	ROTARY SWITCH	A4
2	(B)	增加註解與柄長7.80	OCT-25-2010			
3	(C)	料號變更參照ECN N1037	DEC-02-2010			
4	(D)	CONN標示變更參照ECN GC11081,350±100g變更±150g	SEP-05-2011			
5	(E)					
				DWG NO.	RT-0C8	UNIT
				REV. 圖號	(C)	mm
				REV. 版本	E	SHEET
				CHECKED BY	日期	張數
				RICHARD	JAN-07-2010	1 of 1
				DRAWN BY	製圖	Jack_Lun