

## Screw

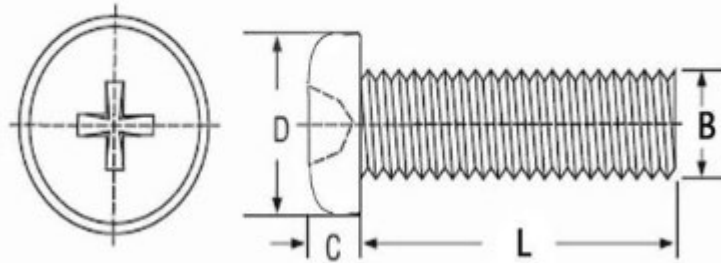

## Metric Thread

Screw size	d Thread diameter	L Thread length	C Head thick± 0.2mm	D Head diameter ± 0.4mm	Pitch
<b>M3*6mm</b>	M3 (3mm)	6mm	2mm	5mm	0.5mm
<b>M3*8mm</b>		8mm			
<b>M3*10mm</b>		10mm			
<b>M3*12mm</b>		12mm			
<b>M3*15mm</b>		15mm			
<b>M3*20mm</b>		20mm			
<b>M3*25mm</b>		25mm			
<b>M3*30mm</b>		30mm			