

CUSTOMER'S NAME

員享

ALPHA REFERENCE NO.



SP06110044

SPECIFICATION

PART NO.	ALPHA MODEL NAME
1.	RV24A01-40-15K-B500K

MODEL NAME
MODEL NO.

APPROVAL

PREPARED BY	REVIEWED BY	APPROVED BY
 95.11.2 麗君	 95.11.3 建志	 95.11.3 捷



台灣艾華電子工業股份有限公司

桃園市中正路1221~1223號9樓

TAIWAN ALPHA ELECTRONIC CO., LTD.

9F, NO. 1221, Chung Cheng Rd., Taoyuan, Taiwan

TEL:886-3-3577799 FAX:886-3-3577700

E-mail:sales@taiwanalpha.com.tw

URL:http://www.taiwanalpha.com

SLH-008-27

THIRD ANGLE PROJECTION

SHAFT SHOWN IN FULL C.C.N. POSITION.

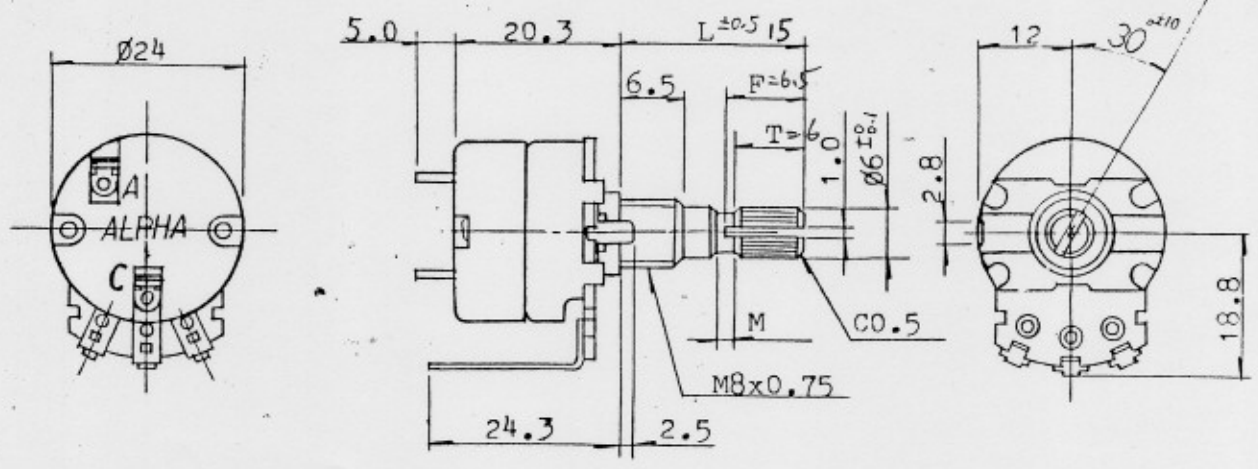

TERMINAL DETAIL
MATERIAL-IRON

SW TERMINAL DETAIL

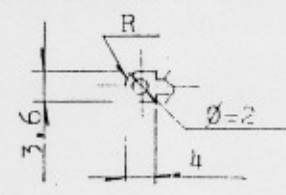
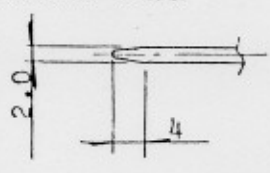
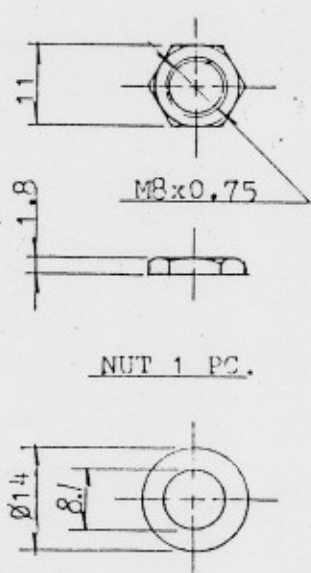

WASHER 2 PCS. t=0.4

P.C.B. MOUNTING DETAIL
(VIEWED FROM MOUNTING SIDE)

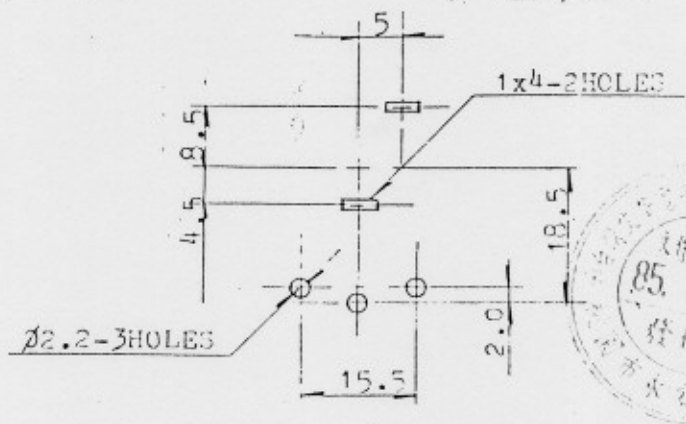

				RV24A01-40-K			
				V24A(020)S(UPW) KQ			
No.	DATE	DESCRIPTION	PART No.	NAME	NOTE		
TOL UNLESS OTHERWISE STATED		DIMENSION	SCALE	DRAWN BY	CHECKED BY	APPROVED BY	DRAWING No.
less than	10	±0.3	mm	江 84.11.29 進三	江 84.11.29 進三	E.H. Wang	4
above	10~30	±0.5					
above	30~100	±1.0					
ANGLE		±5°					

SLH-008-27

CUSTOMER'S NAME	員亭	NOTE	DATE
CUSTOMER'S PART NAME			NOV.03.2006
CUSTOMER'S DRAWING NO.			

1. MECHANICAL SPECIFICATION

1. OUTSIDE DIMENSION	append fig.		
2. TOTAL ROTATION ANGLE	degree	300	±5°
3. TOTAL TRAVEL STROKE	mm		±0.5
4. NUT WRING STRENGTH	twisting moment	less than	kg.cm
5. SCREW TIGHTENING FORCE	torsional moment	less than	kg.cm
6. ROTATION TORQUE	speed 60 deg/sec.	20-200	g.cm
7. SLIDING FORCE	speed 20 mm/sec.		g.cm
8. SHAFT LEVER STRENGTH	pulling pushing	more than	kg
9. SHAFT LEVER WOBBLE	within mm (bending moment)		g.cm)
10. SHAFT LEVER STOP STRENGTH	more than 6 kg.cm (static load)/	60	sec
11. TERMINAL STRENGTH	more than 500 g.cm/10±1sec		
	soldering heat 300±5°C/3sec. 200g.cm/10±1 sec.		
	resist change within ±2%		
12. CLICK POSITION & TORQUE	g.cm		
13. SWITCH WORKING ANGLE (STROKE)	degree (mm)	50°±10°	
14. SWITCH WORKING TORQUE (FORCE)	g.cm	800gf.cm Max	
15. SWITCH CIRCUIT		S.P.S.T.	

SHAFT

MATERIAL	ANGLE OF FLAT OR SLOT		DIMENSION			
	θ	at	M	L	F	T
ALUMINUM				15	6.5	6.0

MODEL NAME	DRAWING NO.
RV24A01-40-15K-B500K	

2. ELECTRICAL SPECIFICATION

1. OVERALL RESISTANCE & TOLERANCE	terminal 1-3	500KΩ ± 20 %
2. TAP RESISTANCE & TOLERANCE	terminal 1-4	Ω ± %
3. RATED WATTAGE	temp. 0~50°C	0.5 W
4. MAXIMUM WORKING VOLTAGE		500 V
5. RESISTANCE TAPER MEASURING POINT & TOLERANCE		B 50 %point 40 ~ 60 %
6. RESIDUAL RESISTANCE	terminal 1 / 3 side	less than 20 / 20 Ω
7. TAP RESIDUAL RESISTANCE	terminal 4 side	less than 100Ω
8. SLIDE NOISE		less than 47 mV
9. INSULATION RESISTANCE	more than	100MΩ (DC) 500 V)
10. WITHSTAND VOLTAGE	AC 500 V	1 minute
11. TRACKING ERROR		
12. SWITCH CONTACT RESISTANCE	MΩ	less than 50 mΩ
13. SWITCH RATING		AC125V, 1A

3. USABLE TEMPERATURE. RANGE: from -10°C to 70°C

4. VR LIFE 15,000 ± TIMES
RESISTANCE CHANGE: within ± %
SLIDE NOISE: Less than mV

SW LIFE 10,000 ± TIMES
CONTACT RESISTANCE: less than mΩ

PREPARED BY	REVIEWED BY	APPROVED BY	REFERENCE NO.	REV.
			SP06110044	

STANDARD RESISTANCE TAPER

WITH SWITCH

SINGLE B TAPER

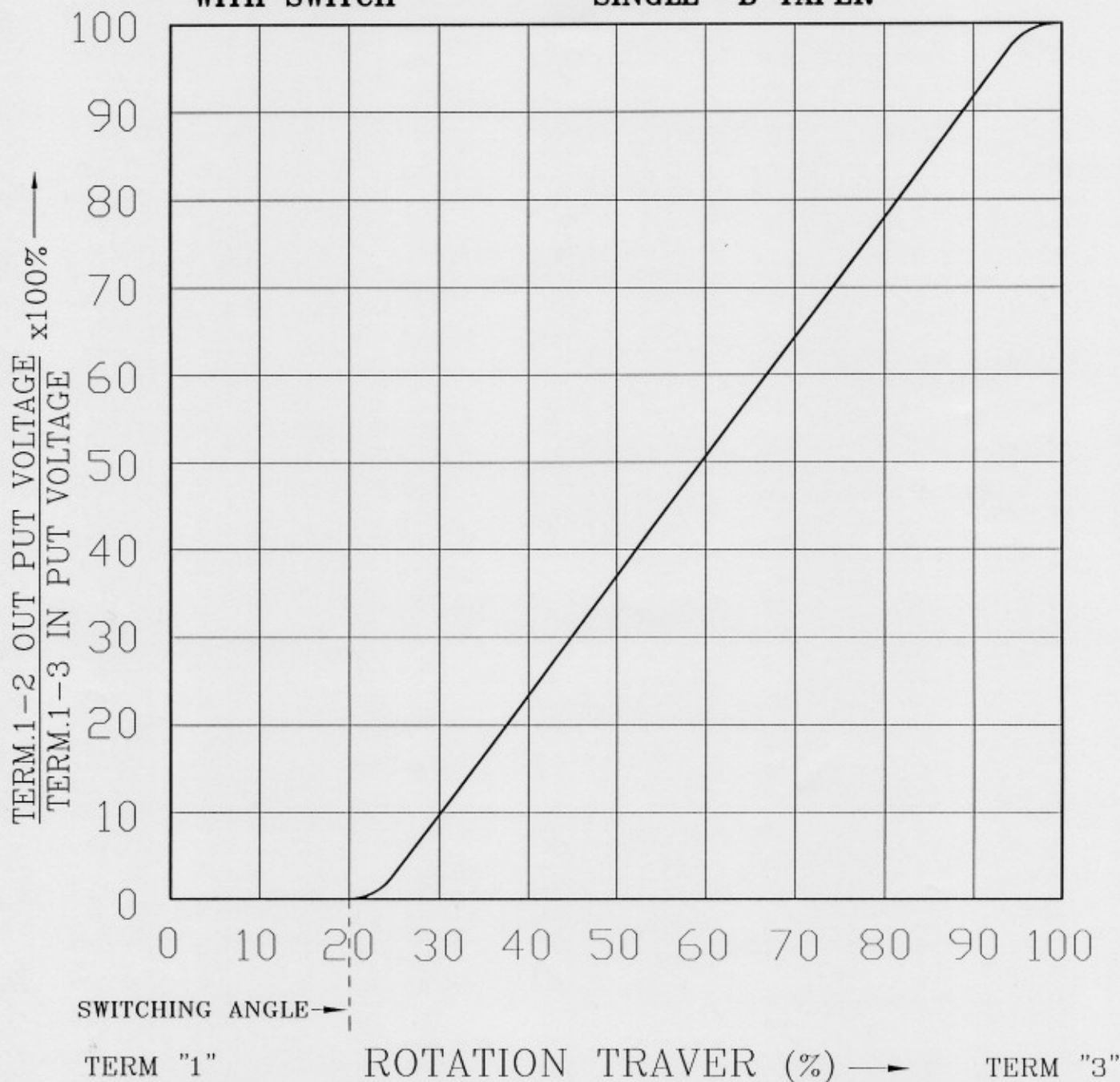

RV24A01(F)系列

NO.	DATE	DESCRIPTION	MODEL NAME				
TOL. UNLESS OTHERWISE STATED		DIMENSION	SCALE	DRAWN BY	CHECKED BY	APPROVED BY	DRAWING NO.
less than 10 ±0.3		mm		何	馬	楊	
above 10 ~ 30 ±0.5				95. R. K	95. G. R	95. B. R	
above 30 ~ 100 ±1.0				建志	建志	建志	
above ±5°							

TAIWAN ALPHA ELECTRONIC CO., LTD.

Common Specification of Variable Resistor

VR 共通規格書

1 Condition of

銲錫條件

Soldering shall be certified with following condition.

作銲錫處理時，請確保在下列工作條件。

1-1 Substrate to be soldered: Copper clad laminated phenol board of 1.6mm thickness.

使用基板：t 1.6 mm 銅箔積層板。

1-2 Solder Flux: Flux of 0.82 specific weight in bubbling type solder flux coating apparatus shall be used and bubbling surface height shall be defined substantially as half thickness of substrate. Flux shall not flow up on the substrate surface.

助銲劑：使用發泡式比重 0.82 以上的銲劑，發泡面高大致在基板厚度一半的位置，而助銲劑不可流入基板表面上。

1-3 Preheating: Surface temperature of the substrate shall be settled within 100°C in two minutes.

預熱：基板表面溫度 100°C 以下，2 分鐘以內。

1-4 Soldering: To be performed in 5 seconds within 230°C.

銲錫：230°C 以下，5 秒以內。

1-5 Manual soldering condition : to be performed in 3 seconds within 300±5°C

手銲：300±5°C，3 秒以內。

Please use the above process only one or two times.

以上工程 1 回或 2 回通過即可。